



# QT EcoClad Exterior Wall Panel

## QT Systems

PO Box 6249 Acacia Ridge DC Q 4110 Australia

Ph: +61 7 3272 3424 Fx: +61 7 3272 3406



### Standard QT® EcoClad Panel Fixing - Type 1 (A)

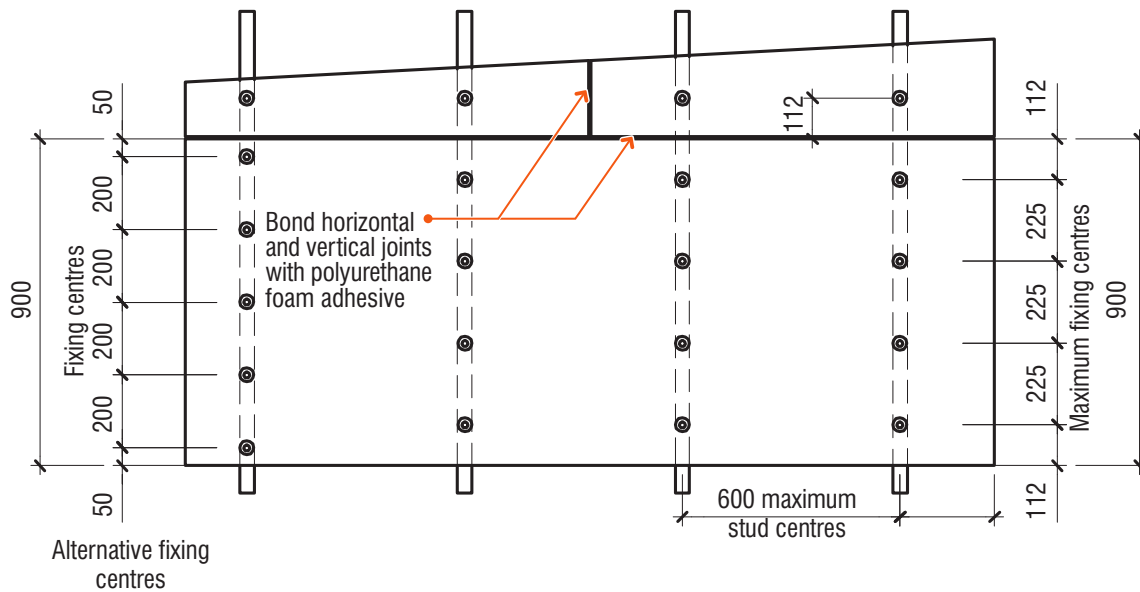

### Wall Panel Fixing Details

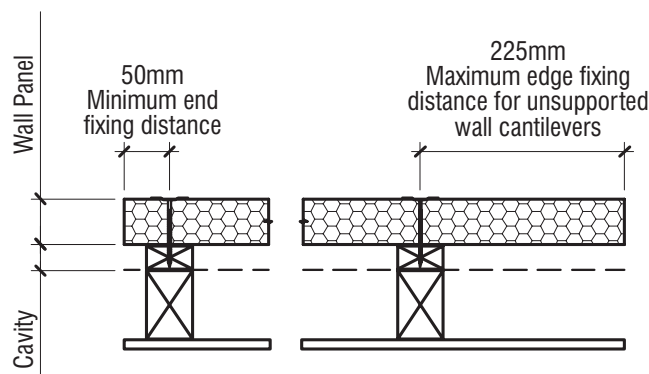

### Wall Panel Edge Fixing Details

#### Panel Fixing

Fix the 50mm QT®EcoClad Wall Panels onto battens with galvanised 10g x 75mm class 3 (AS3566) screws with the addition of QT®Button in all cases.

#### General Notes

1. Panels must span and be fixed across a minimum of two metal battens.
2. Panels shall be installed horizontally in a stretcher bond pattern.
3. Panels must be installed level and plumb to achieve the best possible finish.
4. A vapour permeable sarking must be installed prior to installation of battens.



# QT EcoClad Exterior Wall Panel

**QT Systems**

PO Box 6249 Acacia Ridge DC Q 4110 Australia

Ph: +61 7 3272 3424 Fx: +61 7 3272 3406



## Standard QT® EcoClad Panel Fixing - Type 2 (A)

Bond horizontal and vertical joints with polyurethane foam adhesive.

Trimdek or Spandek profiled wall sheeting

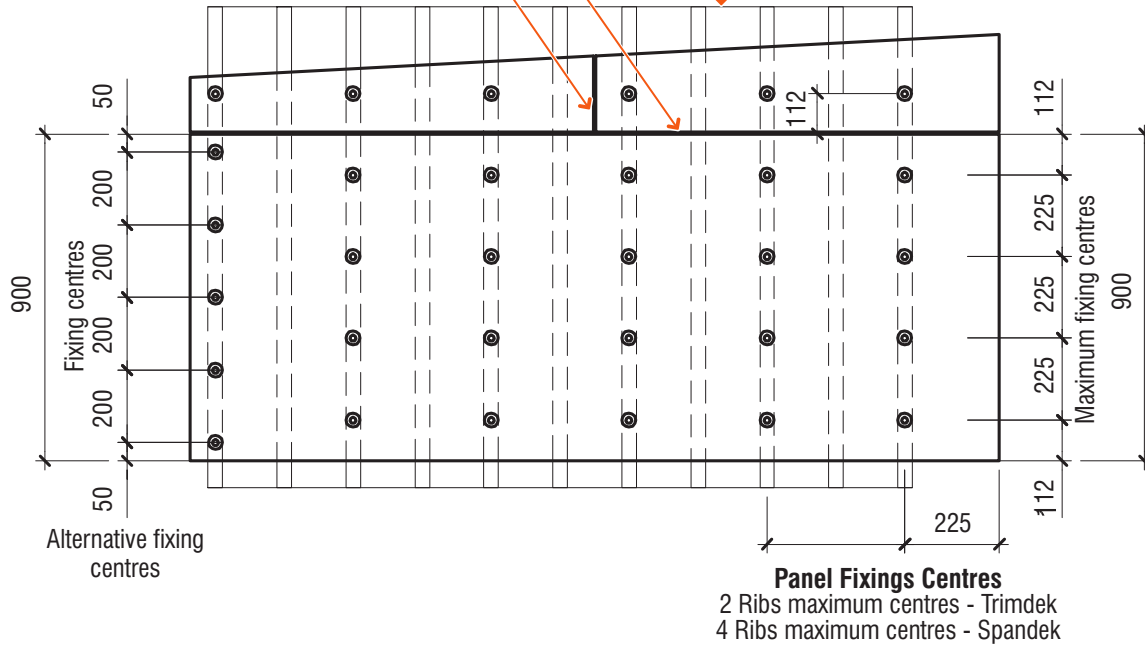

## Wall Panel Fixing Details

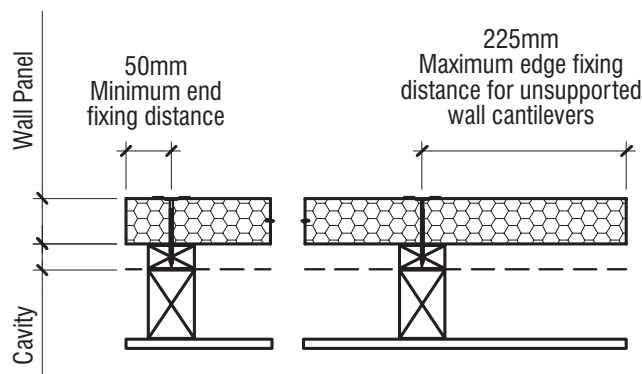

## Wall Panel Edge Fixing Details

### Panel Fixing

Fix the 50mm QT®EcoClad Wall Panels onto battens with galvanised 10g x 75mm class 3 (AS3566) screws with the addition of QT®Button in all cases.

### General Notes

1. Panels must span and be fixed across a minimum of two metal battens.
2. Panels shall be installed horizontally in a stretcher bond pattern.
3. Panels must be installed level and plumb to achieve the best possible finish.
4. A vapour permeable sarking must be installed prior to installation of battens.



# QT EcoClad Exterior Wall Panel

**QT Systems**

PO Box 6249 Acacia Ridge DC Q 4110 Australia

Ph: +61 7 3272 3424 Fx: +61 7 3272 3406



## Type 1 (A) - Batten Fixings

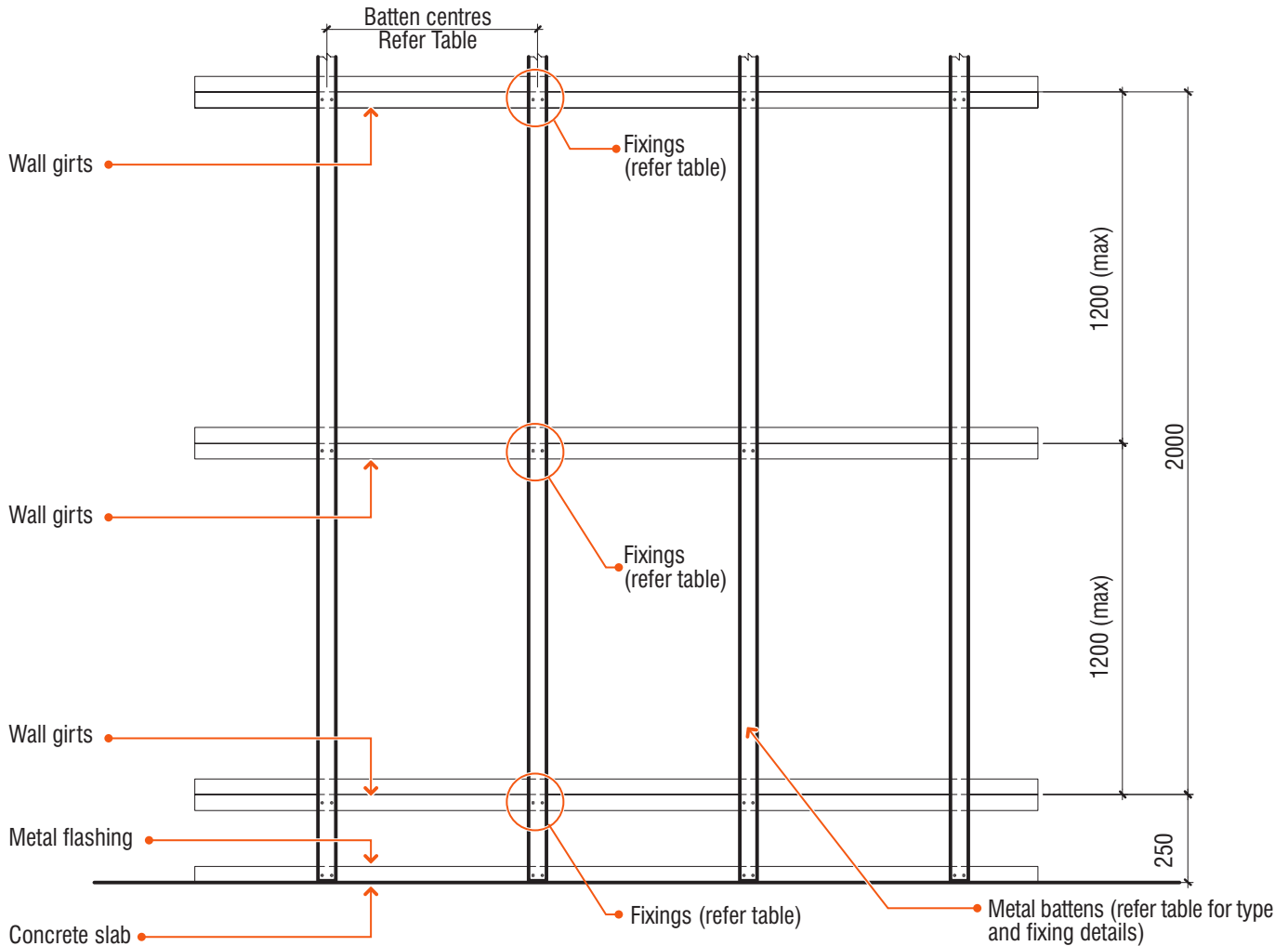

Wind Classification	Batten Spacing at 600 crs		Batten Spacing at 450 ????
	BHP, STRAMIT 0.55 BMT	BHP, STRAMIT 0.75 BMT	BHP, STRAMIT 0.55 BMT
N2(W33N)	2-off - 10-16mm Class 3, Self Drilling Hex Head Screw with Neo Washers	2-off - 10-16mm Class 3, Self Drilling Hex Head Screw with Neo Washers	2-off - 10-16mm Class 3, Self Drilling Hex Head Screw with Neo Washers
N3(W41N)	2-off - 10-16mm Class 3, Self Drilling Hex Head Screw with Neo Washers	2-off - 10-16mm Class 3, Self Drilling Hex Head Screw with Neo Washers	2-off - 10-16mm Class 3, Self Drilling Hex Head Screw with Neo Washers
N4(W50N)	2-off - 10-16mm Class 3, Self Drilling Hex Head Screw with Neo Washers	2-off - 10-16mm Class 3, Self Drilling Hex Head Screw with Neo Washers	2-off - 10-16mm Class 3, Self Drilling Hex Head Screw with Neo Washers
N5(W60N)	-	2-off - 10-16mm Class 3, Self Drilling Hex Head Screw with Neo Washers	2-off - 10-16mm Class 3, Self Drilling Hex Head Screw with Neo Washers
N2(W70N)	-	-	2-off - 10-16mm Class 3, Self Drilling Hex Head Screw with Neo Washers

### General Notes

1. Metal Batten must have two fixings (as per table) in each wall girt.
2. Structural Steel Frame including wall girts must be designed by an engineer and must allow for the applied load of the 50mm Conpolcrete® (20kg/m<sup>2</sup>).
3. All screws must be a minimum class 3.
4. External wall sheeting must be fixed through the 50mm Conpolcrete® Wall Panel and into the wall girts (extended wall sheeting screws required).



# QT EcoClad Exterior Wall Panel

**QT Systems**

PO Box 6249 Acacia Ridge DC Q 4110 Australia

Ph: +61 7 3272 3424 Fx: +61 7 3272 3406



## Type 2 (A) - Wall Sheet Fixing

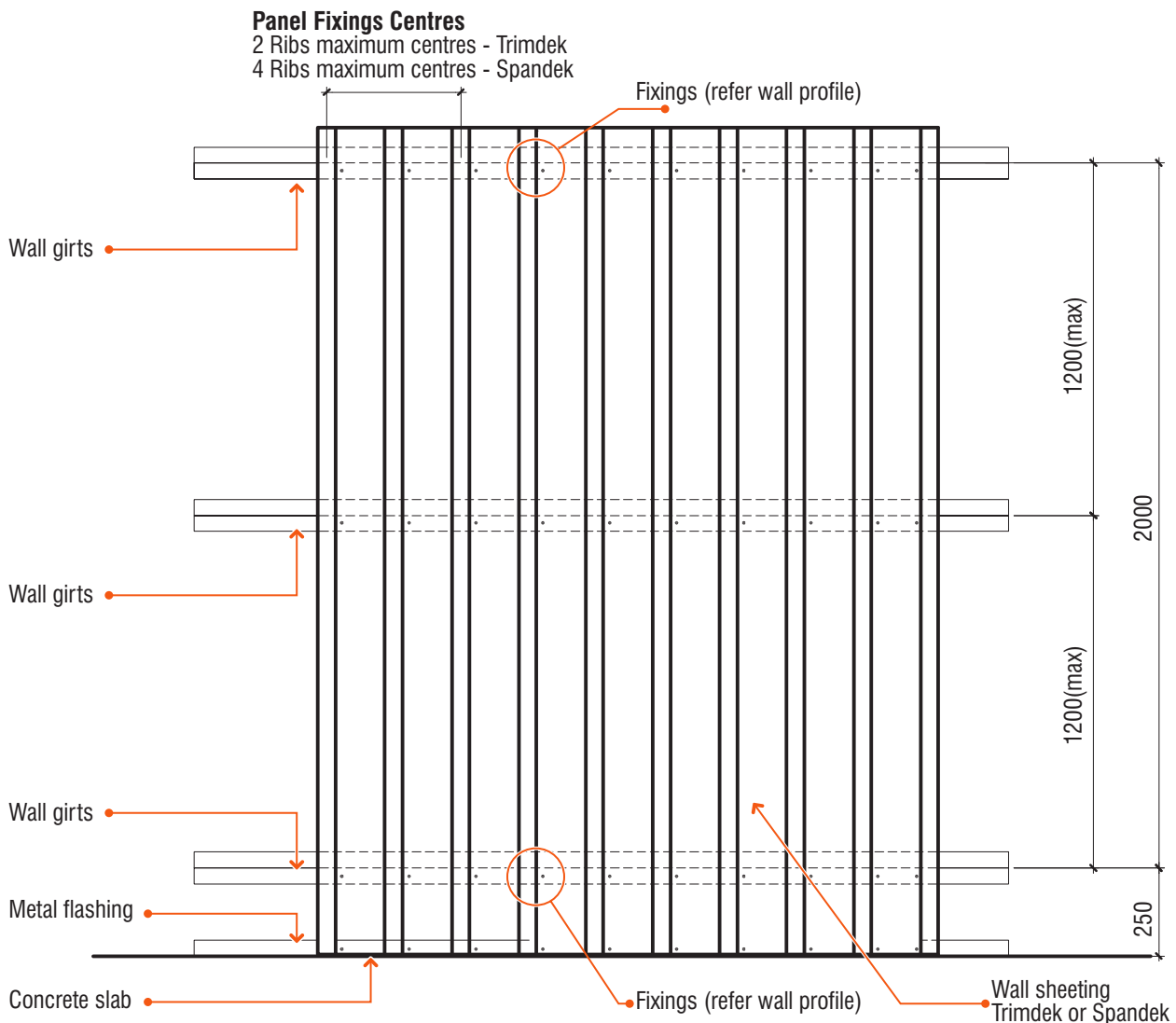

### Trimdek or Similar Profile

1. Trimdek Base Wall Sheeting - must be valley fixed beside each rib with 10-16 x 16mm class 3, self drilling, hex head screws with neo washers at each wall girt. (0.42 BMT Zincalume or Colorbond).
2. Trimdek External Wall Sheeting - must be fixed through the 50mm Conpolcrete® wall panel and into each wall girt beside each rib with 14-10 x 115mm Class 3, self drilling, hex head screws with neo washers. (0.42 BMT Zincalume or Colorbond).

### Spandek or Similar Profile

1. Spandek Base Wall Sheeting - must be valley fixed beside every second rib with 10-16 x 16mm class 3, self drilling, hex head screws with neo washers at each wall girt. (0.42 BMT Zincalume or Colorbond).
2. Spandek External Wall Sheeting - must be fixed through the 50mm Conpolcrete® wall panel and into each wall girt beside every second rib with 14-10 x 115mm Class 3, self drilling, hex head screws with neo washers. (0.42 BMT Zincalume or Colorbond).